



Doodle 'N Draw Travel Table

Assembly Instruction

NO. 5049-04

Ages: 3+



- Adult assembly required. No tools required.
- This item must be used on level ground. DO NOT use on an uneven surface.
- Adult supervision advised when item is in use.
- DO NOT sit or stand on the table. Table may tip or fall which could result in serious injury.



WARNING: CHOKING HAZARD - Small parts. Not for children under 3 years.

This toy contains magnets or magnetic components. Magnets sticking together or becoming attached to a metal object inside the human body can cause serious or fatal injury – seek immediate medical help if magnets are swallowed or inhaled. Strangulation hazard. Long cord.

ASSEMBLY INSTRUCTIONS

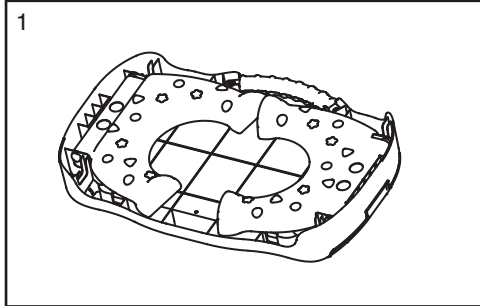

Turn the table upside down.

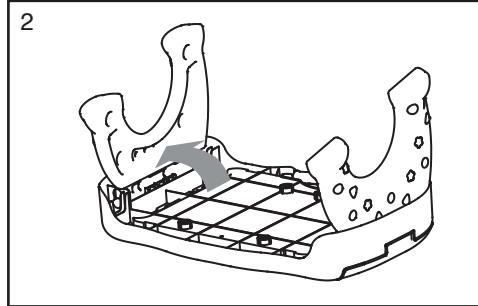

Lift up the legs to the upright position.

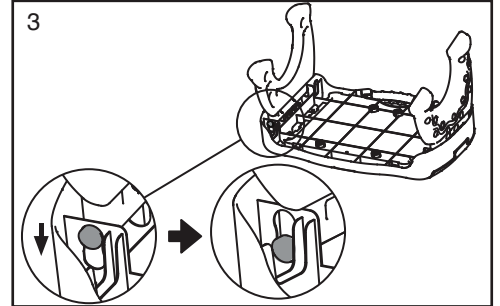

Press legs down firmly to snap pegs into slots. Pull legs up to unlock before folding.

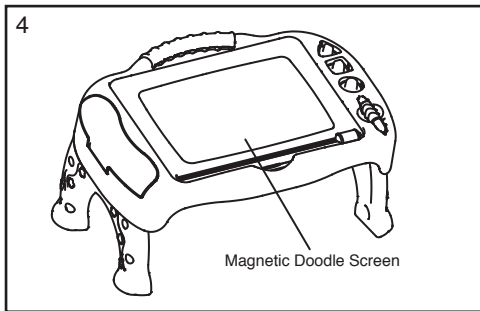

Picture shows the final assembly product.

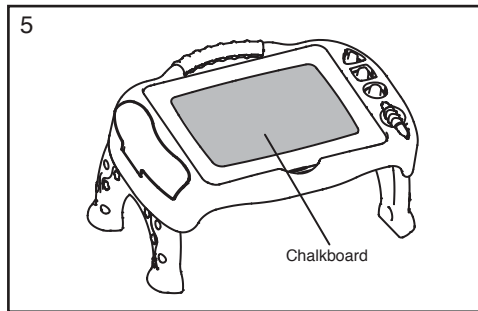

Choose the preferred side (doodle screen / chalkboard) to use and snap onto the tabletop to hold securely.

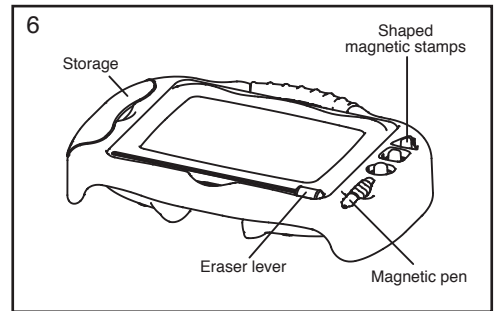

Draw on the table propped up or lying flat. To use lying flat, fold the legs back under the table.

SAFETY AND MAINTENANCE

1. Make sure that all the pegs are securely tapped together before use.
2. Please check the unit regularly for any worn-out parts. The item must be securely assembled to avoid injury.
3. If the Magnetic Doodle Screen becomes damaged or leaks, stop using immediately. Continued use may be a safety hazard.

CARE INSTRUCTIONS

- This item was made for INDOOR use. DO NOT attempt to use or expose the unit outdoors. The drawing surfaces are weather sensitive, any wetness or excessive dampness will ruin the boards.
- Wipe with a clean cloth dampened with a mild soap and water solution. Do not immerse this toy.

Magnetic Doodle Screen

- **IMPORTANT: TO AVOID DAMAGE TO THE DOODLE SCREEN**, use only the magnetic pen included. DO NOT use pencils, pens, crayons, markers or any other sharp pointed objects on the doodle screen. Scratching will cause permanent damage. Treat the screen surface with care.
- Before first-time use, completely darken the doodle screen with the magnetic pen. Slide the eraser lever from side to side to clear the doodle screen. Repeat this procedure several times to enable the doodle screen to create the clearest, darkest images.
- DO NOT apply heavy pressure or force to the doodle screen. Heavy pressure is not necessary and could damage the surface.
- DO NOT leave the shaped magnetic stamps on the doodle screen. Completely erase the drawing surface before storing for an extended period of time.
- Keep this toy away from extreme heat sources such as ovens, heaters and radiators.

Chalkboard

- Chalkboard must be treated prior to use. To season: hold Crayola® Anti-Dust® or school chalk on the flat side (not the point side) and using broad flat strokes, coat the board both horizontally then vertically, making sure to cover the entire board surface. Wipe off the chalkboard with a **slightly damp** sponge (or paper towel). Any excessive water may damage the board.
- Crayola® Anti-Dust® or school chalk (Calcium Carbonate Based) is recommended for use on the chalkboard surface. DO NOT use Crayola® Sidewalk Chalk or other "street chalk" as it contains abrasives that will damage the board.

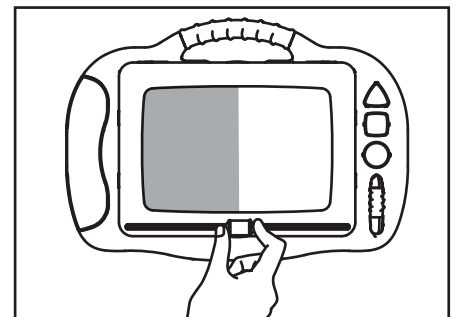

LIMITED WARRANTY

Our products are covered under warranty for a period of 60 days from the date of purchase, under normal use and service, against defective workmanship and material. If you have recently purchased this product and find it to be defective in anyway, kindly return it to the "Source of Purchase" for a Full Refund or Exchange. Should the product no longer be covered by your Purchase Receipt, or should you have any questions pertaining to our product, please call our Toll Free Customer Service for assistance. Keep a copy of the UPC Code with proof of purchase receipt for any future Warranty Service. Please retain packaging and assembly instruction for future reference.

Official Licensed Product

CUSTOMER SERVICE

USA and Canada: service@grow-n-up.com

Toll free hotline: 1-888-468-9898

Other countries: support@grow-n-up.com

www.grow-n-up.com

©2014 Crayola.

Grow'n up Limited. All Rights Reserved.

Room 808B, New Mandarin Plaza, Tsim Sha Tsui, Kowloon, Hong Kong.

MADE IN CHINA (SZ)